

Eagan Manufacturing Co., Inc.
P.O Box 620
Black Rock, AR 72415
870/878-6805 Fax 870/878-6280
www.eaganmfg.com

Form EWV1001R3

INSTALLATION & MAINTENANCE INSTRUCTIONS

WV Wall Vents



Model WV Series Vents



Instructions for Installing Vinyl Wall Vent Throwers

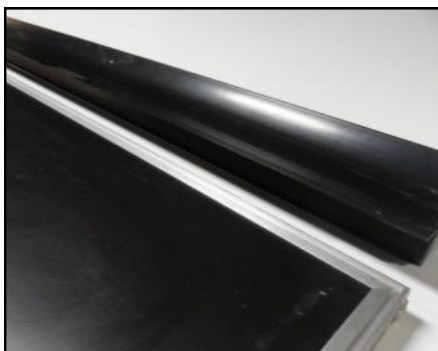

◀ **Step 1:** Locate one wall vent panel, one vinyl curved thrower and the necessary screws. The thrower will always curve towards the black side of the panel. If you requested custom panels that are white on both sides, the curve of the thrower will extend away from the small lip on the extrusion surrounding the perimeter of the panel.

▶ **Step 2:** Locate the small “tab” on the vinyl curved thrower. This will be “snapped” into the channel of the extrusion on the back (white side) of the wall vent panel. Then slowly roll the curved thrower over the top of the wall vent panel.



◀ **Step 3:** Once the “tab” is located in the channel of the extrusion and the thrower has been rolled over the extrusion, you are ready to secure the vinyl thrower to the wall vent panel.

▶ **Step 4:** Locate the pre-drilled holes in the vinyl thrower, as well as the provided screws. Carefully screw together the vinyl curved thrower and the wall vent panel.



◀ **Step 5:** Do not over tighten the screws. Doing so may crack or damage the vinyl throwers. To ensure the proper installation of the vinyl throwers, we recommend that you install a wall vent into the house before installing the rest of your throwers. If you have questions, please contact us at 870-878-6805.

Framing Opening:

Start framing the opening using a 2x4 or 2x6 depending on post size. The spacing will be the same as the ordered door height. A 10 x 39

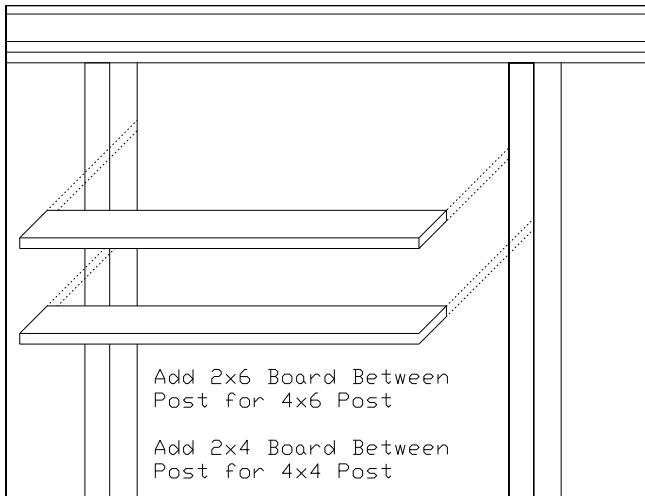

ordered door will have a 10" opening. The actual door will be 5 1/2" taller because of the curve. The width should be 4" smaller than the ordered door size. A 39" door will need a width of 35". The door requires an overlap of

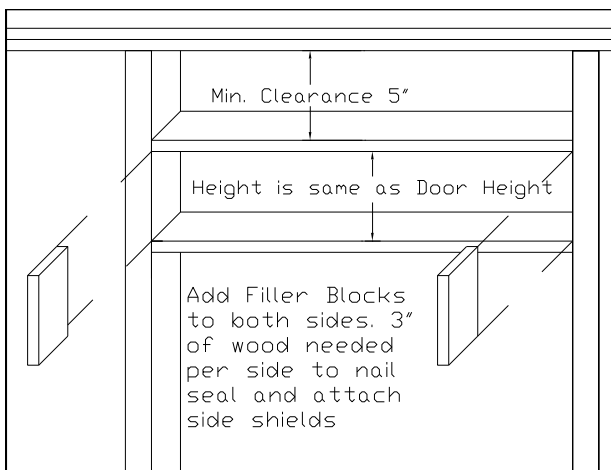

2" per side to maintain a tight seal across the door. Filler blocks may be needed to allow enough room for the seal and the side shields to be mounted. We recommend a 2x6 block mounted next to the post to allow an additional 1 1/2" of material to mount the seal and shield.

The bottom of the frame also needs additional wood for the hinges. The hinge screws are an additional 1/2" below the seal. A total of 2 1/2" of wood is required. If the surface is being covered in 1/2" or thicker plywood the

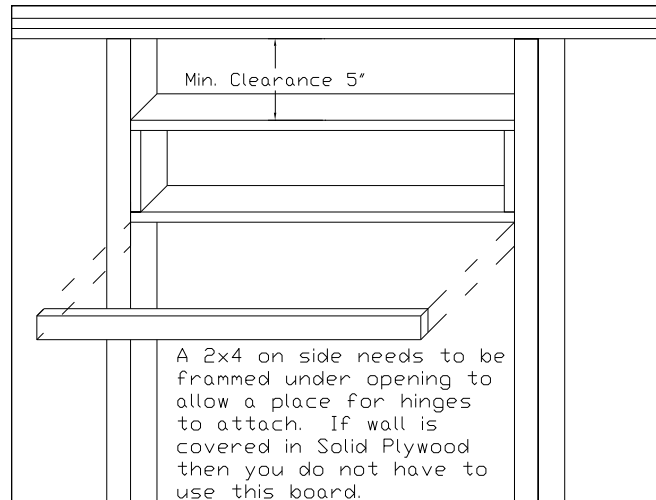

seal and hinges can be mounted to the wood. If OSB is used then a wood subframe needs to be used. The image below illustrates that a total 2 1/2" wood surface needs to be available around the framed hole.

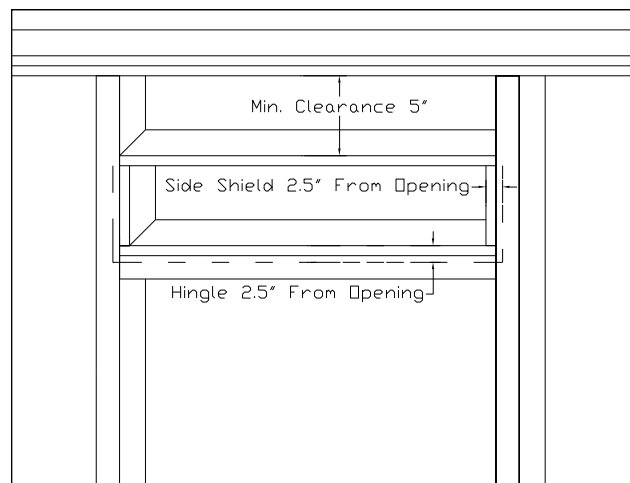

Attaching Seal

Once the opening has been framed the seal can be mounted. The U-Shaped Cove Seal comes already cut and ready to attach. Attach the seal

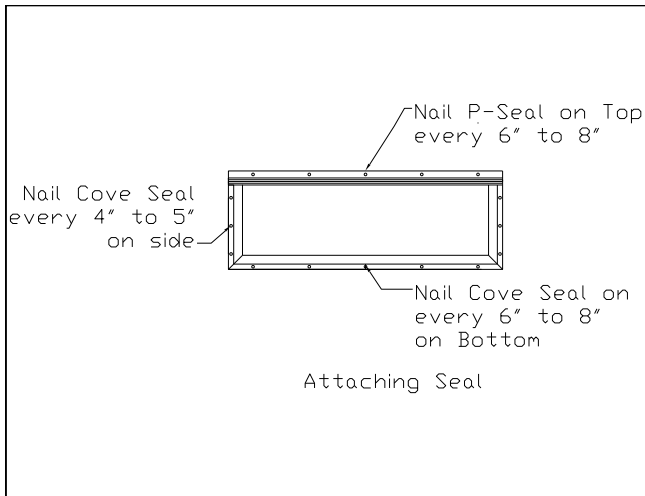

around the hole and nail every 6 to 8 inches. Next, attach the P-Seal at the top with the P part of the seal facing down. Once the seal is up, the door is attached over the seal. The bottom hinges should just touch the lower seal.

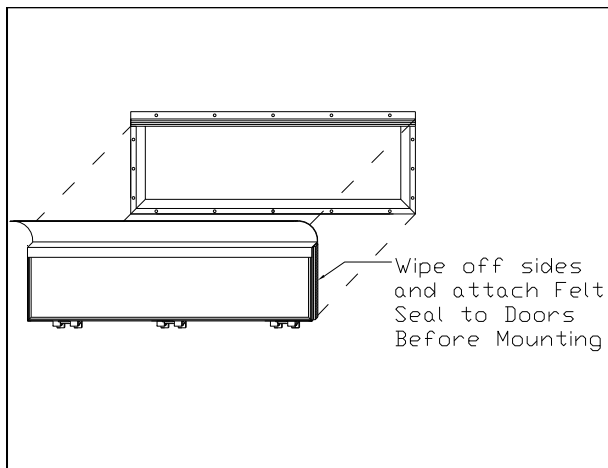

Once the hinges are screwed into the wall, the door should seal all around the opening when closed. On each side of the door a felt seal needs to be attached. The felt seal surface needs to be wiped off with alcohol or acetone before the felt is placed on the door. The adhesive will not work if the door is dirty.

Once the felt has been attached and the doors hung the side shields can now be put on. The side shields need to be lightly pressing against the felt seal. Once the shields are pressing against the felt seal, the screws can be placed



in the shield to hold it in place. Open the door and close it to make sure there is no bind. The only consideration is to make sure there is enough room between the post and to allow room if wall braces are used. The overall size

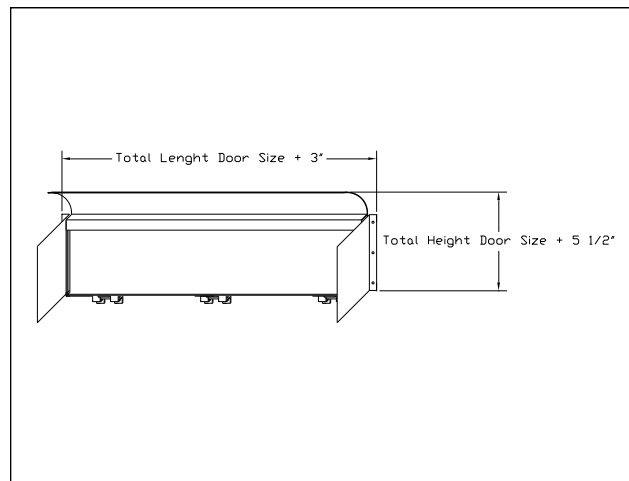

of the completed door will be 7" wider than the framed hole or 3" wider than the actual door.

Example: A 42" door will require a wall space of 45 " and will need a framed hole of 38"

Parts Description

| Item | Qty | Description |
|------|-----|---------------------|
| 1 | 2 | Flet Strips |
| 2 | 1 | Injected Door Panel |
| 3 | 3 | Lower Hinge |
| 4 | 1 | Top Diverter |
| 5 | 2 | Side Shields |
| | | |
| | | |
| | | |
| | | |
| | | |
| | | |
| | | |
| | | |
| | | |
| | | |
| | | |
| | | |
| | | |

