

## Installation Guide Cooler Door

### TABLE OF CONTENTS

|                                   |   |
|-----------------------------------|---|
| Parts .....                       | 1 |
| Framing .....                     | 2 |
| Seal Installation and Track ..... | 3 |
| Hardware Installation .....       | 4 |

### PARTS

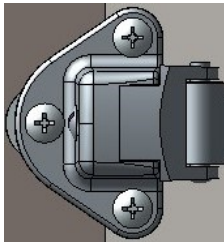

Latch (1)

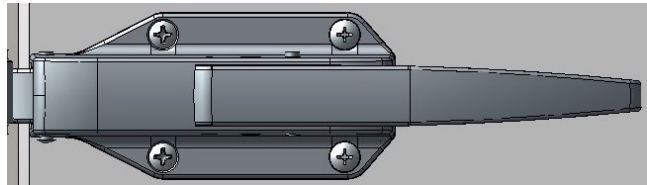

Handle (1)

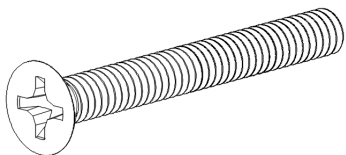

Bolt (2)

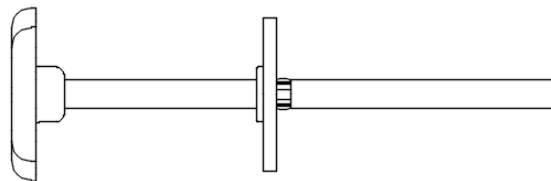

Plunger (1)



Nut (2)

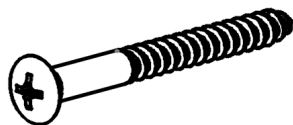

Screw (5)

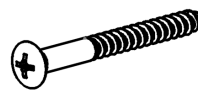

Screw (4)



Washers (3)

## FRAMING

### STEP 1

Insure that the framing is set at  $85 \frac{1}{2}$ " in height and 50" in width as shown below. Slide door into hole and adjust to frame with shims if needed to level door in frame.

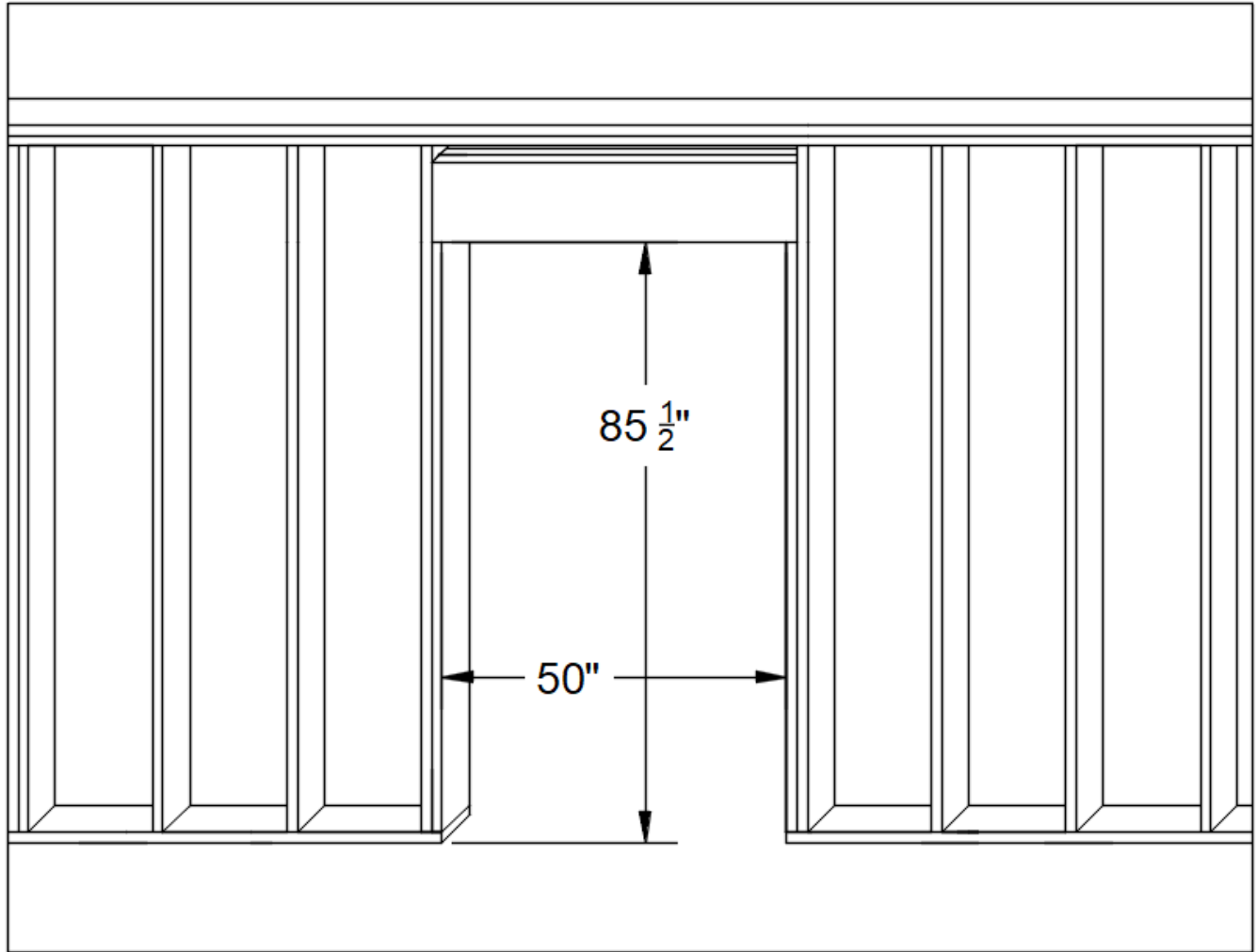

## Cooler Door Handle Installation

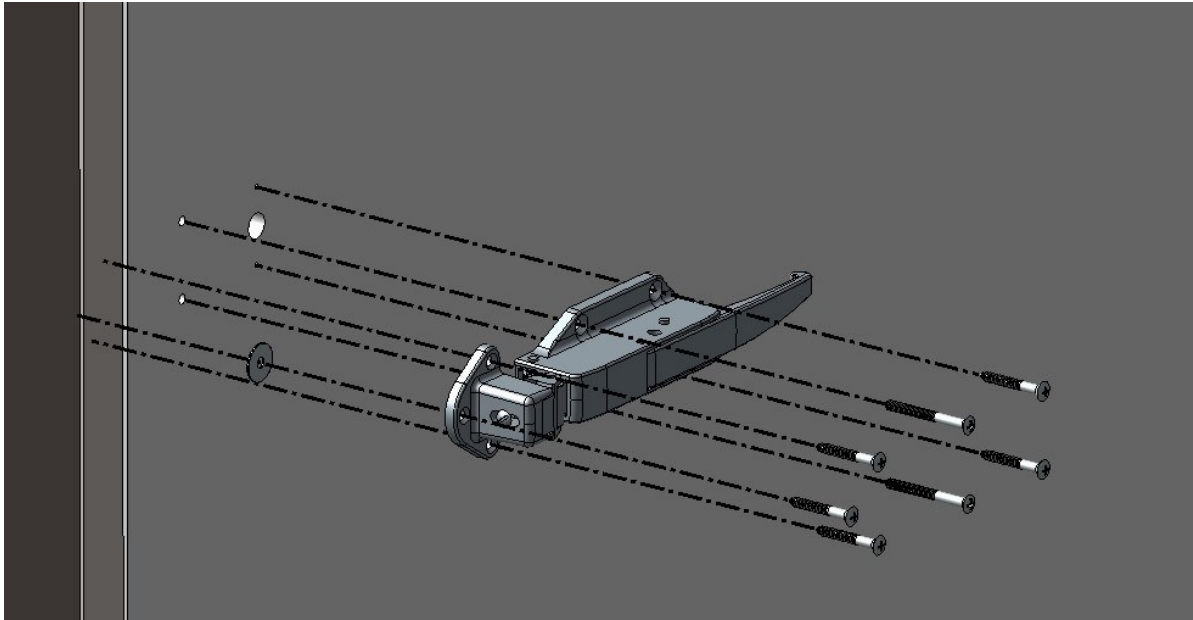

### Step 2.

Install latch on the front of the door. Use Bolts and nuts on the front of the latch first. Then install screws on the back 2 holes.

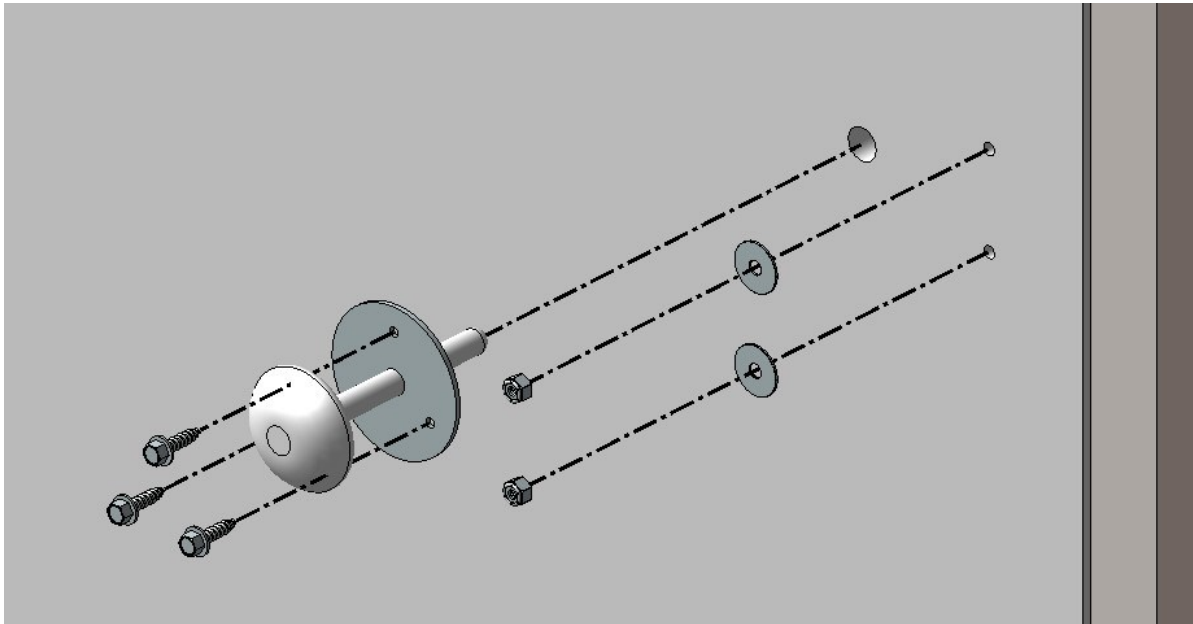

### Step 3.

Make sure that washers are installed on bolts before screwing on nuts. Install plunger with 3 screws. Do not put screws in an angle so the plunger shaft is binding on mounting plate.

## INSTALLING THE SEAL

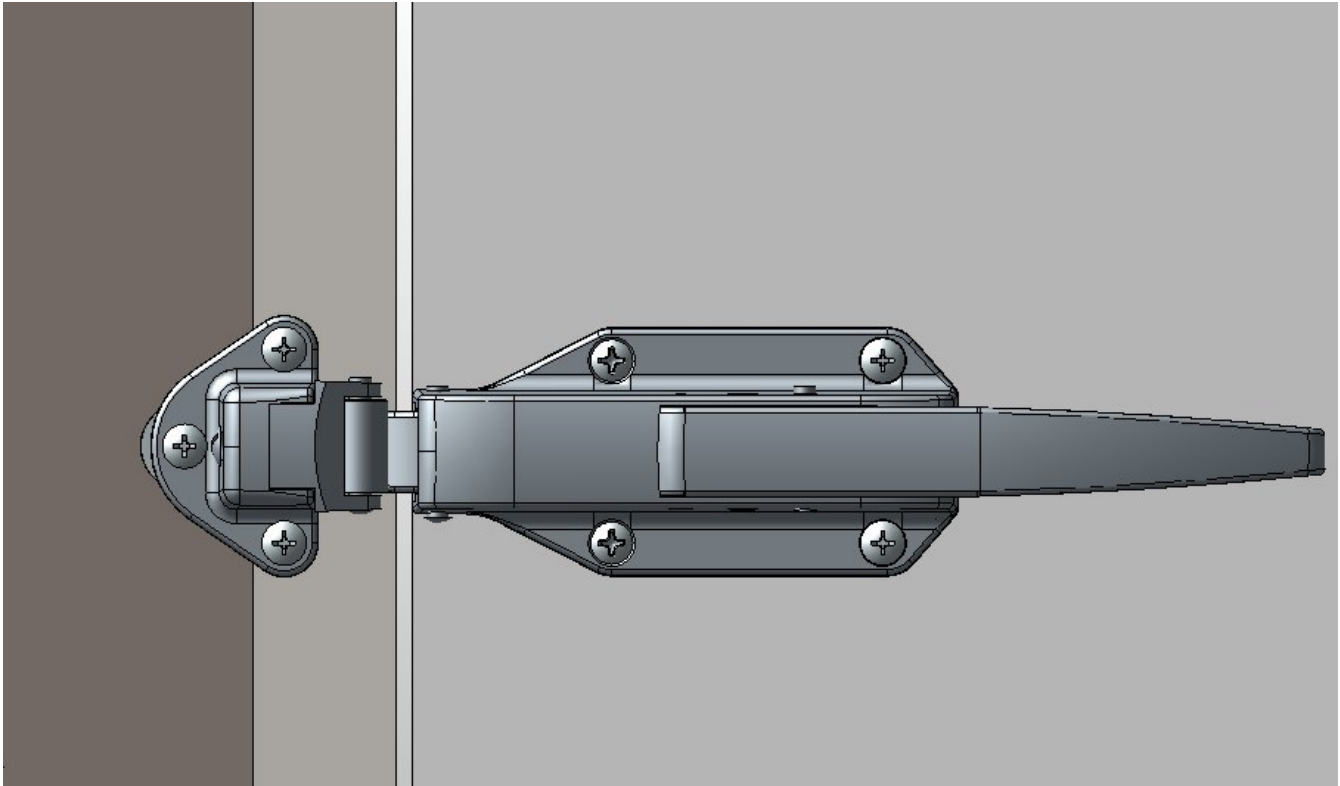

### STEP 4

Install Latch on the side of frame. Set latch to allow good closure of door. Install the first two screws on either side of latch. The back hole needs a washer under it before adding screw.

---

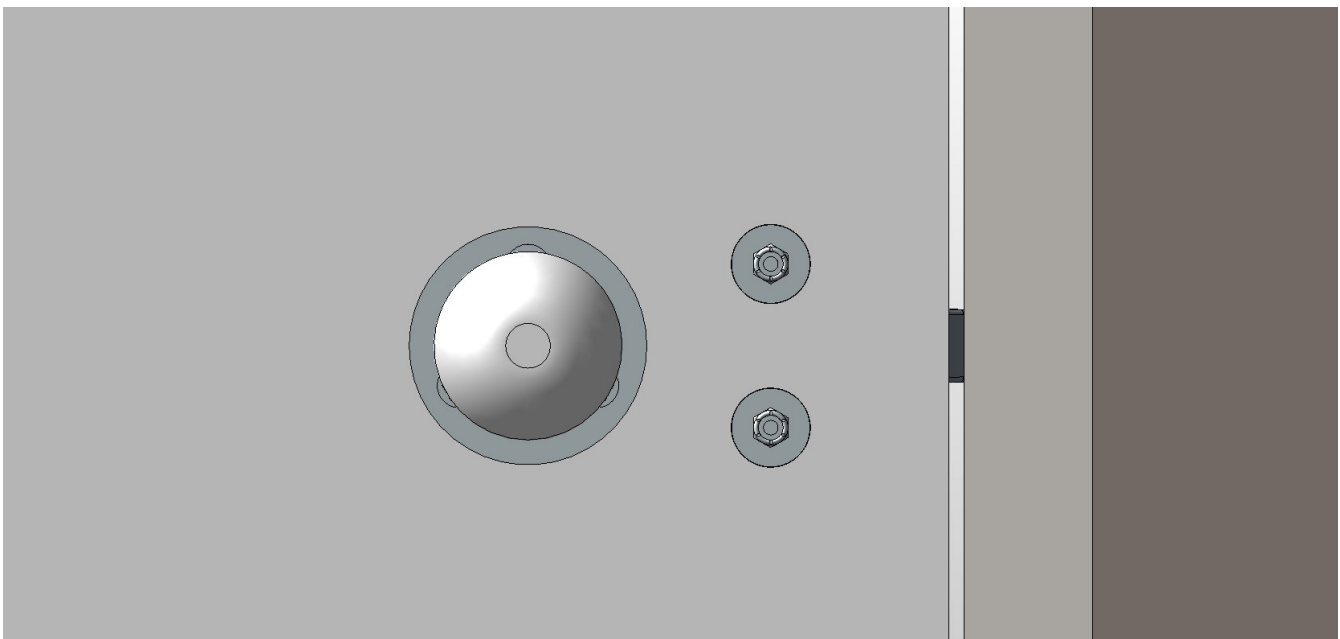

### STEP 5

Install outside door handles